

## Smart RF Remote Control Instruction Manual

GW-1336

### Enjoy the Life

Gingerway Technologies Co.,Ltd

#### Description

Dear users, sincerely thank you for choosing our products. For your convenience of installing and using this product, please read this manual carefully before use.

Gingerway smart RF remote control is a new generation two-way full digital communication remote control. Via this remote control, you can easily control the devices and query the status.

Gingerway smart RF remote control must be used with Gingerway smart switch/socket/curtain controller, etc.

#### Keywords:

**Terminal Node:** The each gang light/socket/curtain and other devices, which can be controlled by Gingerway RF remote control.

**Binding:** Establish a secure connection between gateway and the terminal nodes.

**Scene:** The on-off state combination of multiple remote-controlled terminal nodes. Eg: At the scene "Entertainment", the backlight in the living room can be set to state ON while the curtain OFF and the television ON, etc.

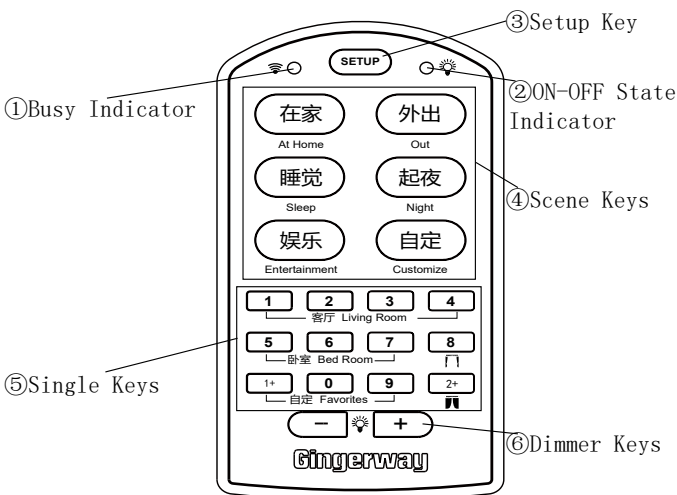

#### This remote control is comprised of indicators and 7 types of keys:

- Busy Indicator** ( Indicator flickers, indicating the remote control is busy in processing, transmitting or receiving data.)
- ON-OFF State Indicator** ( Showing the on-off state of the remote controlled terminal nodes. When the light is on, it means that the current state of terminal node is on; When the light is off, that the current state of terminal is off.)
- Setup Key** ( Being used for binding and unbinding the remote control with the remote-controlled terminal nodes.)
- Scene Keys** ( 6 keys included, one key controls the combinational on-off state of multiple terminal nodes.)
- Single Keys** ( 30 keys included, one key controls the on-off state of single terminal node.)
- Dimmer Keys** ( Adjusting the brightness of terminal nodes.)

#### Installation of the Remote Control – Battery

Remote control battery box is equipped with a new battery, you can use it as long as you remove the protective film of the battery.

If you find the indicator dimmed and the remote control RF range shorten, please replace the battery with a new Li-Mn button cell which type for CR2450.

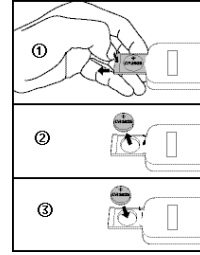

Method for replacing the battery:

- Press the catching groove of remote control and battery box, then pull out the battery box.
- Put into a type CR2450 Li-Mn button cell.  
Note: the side with words (Cathode) side up.
- Push the battery box into remote control and fasten it.

#### Setup

Please bind the remote control with each terminal nodes before use.

#### A. Binding:

- Please skip this step if the terminal nodes are bound with single keys of remote control. If bound with scene keys, the on-off state of the terminal nodes need to be set to your expected status. For example, if you want the backlight in the living room to be on-state at "Entertainment" scene, then the backlight should be turned on before binding.
- Long press the on-off key of terminal node for 5 seconds, release your finger after hearing a long tone of "Di", the terminal node is going to send out a binding request.
- Long press the "SETUP" key of remote control for 5 seconds, release your finger after hearing a long tone of "Di". Then short press the scene key or single key, release your finger, the remote control will emit a short tone of "Di" and response to the binding request.
- If the remote control emit a short tone of "Di", then this binding is successful. You can control the terminal node just by pressing this key.
- If the remote control emit a long tone of "Di", then this binding is unsuccessful, please rebind it again.

#### B. Unbinding:

- Delete all the bindings of a certain key:  
Long press the "SETUP" key of remote control for 5 seconds, release your finger after hearing a long tone of "Di". Then long press the scene key or single key which need to be unbound, release your finger after hearing a long tone of "Di", all the bindings of this key will be deleted. If the scene key had bound with nonexistent terminal nodes, then the nonexistent terminal nodes will be deleted firstly.
- Delete the binding of a scene key with the ON or OFF state of a certain terminal node:  
Rebind it again, the remote control will automatically clear this binding if it find the same binding.

#### Usage

|  |   |
|--|---|
| Press the scene key  | Control the combinational on-off state of multiple terminal nodes.  |
| Press the single key   | Press it once, the on-off state of the terminal node will reverse once. And the result will feedback to the ON-OFF state indicator.<br><b>For the single keys "10" to "29", such as "15", press the key "1+" firstly, then press the key "5".</b> |
| 1. Press the corresponding single key to turn on the dimming node.<br>2. Then press dimmer key | Control the brightness of the dimming terminal nodes.   |
| Long press the single key  | Query the on-off state of terminal nodes.   |
| Long press the scene key   | Reverse the combinational on-off state of multiple terminal nodes in this scene.  |

**Note:** In the process of using the remote control(not including the setup process). If you hear the remote control emit a short tone of "Di", that means this control succeeded; If you hear a long tone of "Di", that means this control failed.

**Technical parameters**

|  |  |
|--|--|
| Power Supply                             | 3VDC, one piece CR2450 Li-Mn button cell |
| Standby Current                          | ≤5uA                                     |
| Wireless Operating Frequency             | 433MHz                                   |
| Wireless Transmit Power                  | ~10dbm                                   |
| Wireless Receiving Sensitivity           | ≤-105dbm                                 |
| RF Control Range                         | about 30m indoor, about 100m outdoor.    |
| Maximum Quantity of Controllable Devices | 32                                       |
| Operating Temperature                    | 0-60℃                                    |
| Relative Humidity                        | ≤80% (Non- condensing)                   |
| Dimension(L* W * H )                     | 99mm * 52mm * 12mm                       |
| Weight                                   | 38~45g                                   |

**Warranty Terms**

Gingerway products are guaranteed for 2 years since the date of purchase. During the warranty period, if Gingerway products malfunction(not contain artificial damages) under normal circumstances, they can be free repaired or exchanged at local dealer with the purchase invoice.

1. If due to quality failure during the warranty period, the maintenance is free in first year, only the component cost will be charged in the second year.

2. Disassembling Gingerway product components without the permission of our company or the local client center, our company will no longer bear the free warranty responsibility .

Note: Shenzhen Gingerway Technologies Co., Ltd reserves the right of final explanation for above terms.

**Delivery List**

1. Gingerway Smart RF scene remote control.
2. CR2450 Li-Mn button cell.
3. Instruction Manual.

Shenzhen Gingerway Technologies Co., Ltd.  
 Address: 3-Floor, Building A6, Xingye Industrial Park, Zhongshanyuan No.2 Road, Nanshan District. Shenzhen, Guangdong, China.  
 Tel :0755 -28779595 Fax :0755 -28779405  
 Website: www.gingerway.com